



# 崧興工業股份有限公司

Sung Hsin Industry Co., Ltd. [www.sunghsin.com.tw](http://www.sunghsin.com.tw)

台灣第一品牌

振動馬達 / 內轉齒輪泵浦

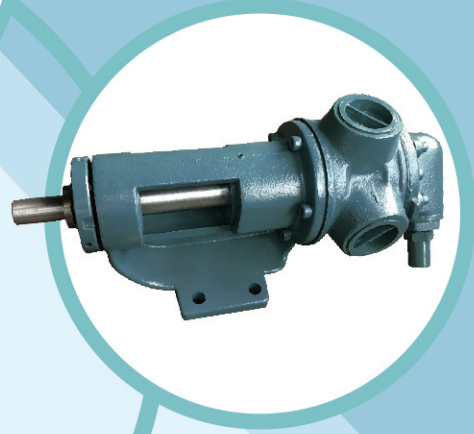
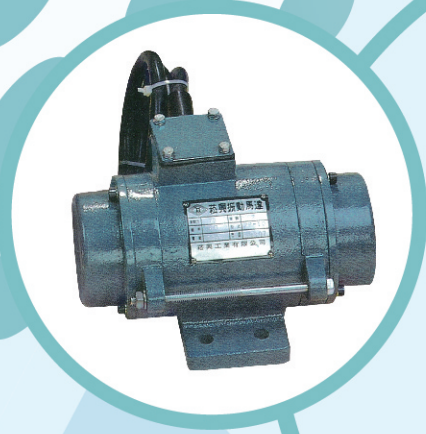

始終追求卓越品質

# VIBRATING MOTOR



台灣第一品牌

## 公司簡介

崧興工業為專業製造電動振動馬達的製造廠，一般使用範圍極為廣泛，產業界的充填壓縮，流出選別，搬運等方面之利用。

公司秉持永續經營及企業發展的方向努力，用著以往所有製造電動振動馬達的經驗，帶領公司同仁創造高品質的產品來滿足客戶需求。

Professional manufacturing vibrating motor. Its application is versatile, such as banking/pouring compaction, out-flowing selection, and shipping/handling operations in industrial field. We insist on everlasting business and exert for enterprise development. With abundant manufacturing vibrating motor experience, we guide our company to make high quality products to meet customers' demands.





# 電動振動馬達 VIBRATING MOTOR

軸承均採用原裝進口 All bearings are imported from original packaging



振動機械是將振動馬達加裝於機械之上，馬達轉動後產生之振動與機體結合產生共振，使其上之物體依所需之方向與角度移動。

So-called vibrated mechanism refers to those to have been equipped with the vibrating motors. When the motor is actuated to produce vibration which would be in consonance with mechanism action, so to in turn push the carried objects moving toward designed direction at designed angle.

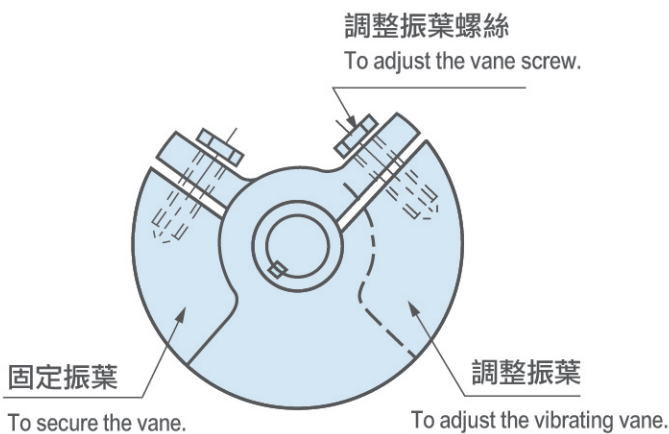

■ 葉片詳細圖  
The break-down figure of vane

■ 振幅調整  
The adjustment of vibration amplitude

兩側調整振業與固定振葉之角度，可加減變換與所需動力配合

To adjust the angle of both lateral vibrating vanes and the fixed vanes in order to meet power requirement.

■ 平面總圖  
The master plane graphic

離心力 Centrifugal force.	12.5%	40.5%	71.5%	93%	100%	42.8%
振葉角度 Vibrating vane angle.	0°	45°	90°	135°	180°	外面的兩端振葉 Vane on Outside Both Ends

# 電動振動馬達 VIBRATING MOTOR

## 安裝調整注意事項

1. 調整振動力前後，必須固定調整螺絲，以防振葉彈出之危險。
2. 正常使用下隨時注意腳架固定螺絲，及延長出口線是否固定妥當。
3. 選擇馬達基座，須考慮基座張力強度是否足夠，以免破損本機機體。
4. 正常使用下，須以運轉3000小時保養一次。

### Precautions in installment and adjustment :

1. Before and after adjusting the vibrating force, it is necessary to secure the adjusting screw in order to prevent the vibrating vanes from jumping out.
2. Constantly check the securing screw on foot and the outlet cord for sure security and normal operation.
3. In selection of motor base, the tensile strength of the base should be taken into consideration so that the mechanism may not be damaged.
4. Under the normal usage, the maintenance practice should be conducted once every 3000 hours of running.

## 振葉詳細圖 The break-down figure of vane

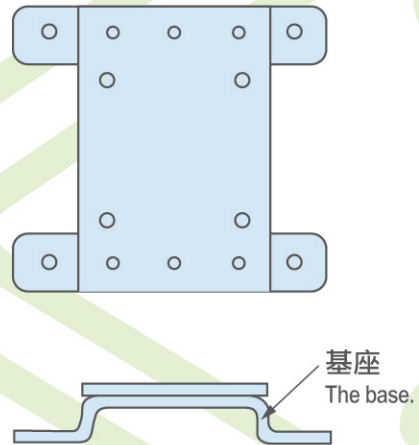
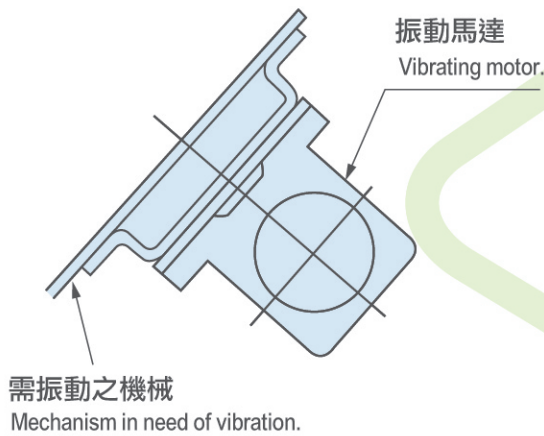

▲ 未使用前  
Prior to operation



▲ 已安裝後  
After installment





## 構造重點

1. 線圈及絕緣處理：馬達線圈是用H絕緣體並經過充分的耐振處理製成。
2. 迴轉軸：係採用堅牢之鉻鋼設計製成以利振葉離心力之負荷。
3. 軸承：本馬達係屬極需振動之產品製造上必然堅固在裝卸時，應注意消耗品之保護即可延長馬達壽命，此馬達所裝置之各種球狀軸承，有極高之壽命記錄且換裝容易。
4. 偏向振葉：安裝時應調整至最適當之振動力後固定於兩端。
5. 延長線出口：延長線出口位置惟恐遭受振動而斷線，故除了用金屬裝備外，另加橡皮圈套保護。(特殊SILICON防振保護)
6. 鋼珠之壽命各型壽命不一，其壽命顯示在三千小時以上，足以顯示此軸有驚人之壽命。
7. 本馬達可長時間運轉。
8. 如需具備防水、防爆之功能以及特殊規格均可特別訂製。

## Primary structure

1. Coil and isolation processing : The motor coil is made of the wire coated with H type isolating paint and received adequate vibrating-proof processing.
2. Rotating shaft: which is made of the rigid chrome steel which is facilitative to the load of vibrating vane centrifugal force.
3. Bearing: This motor is designed and manufactured for the industrial circle in which the vibrating device is mandatory in their production facility, so it must be stable and heavy-duty in structure; however, its consuming spare parts are still in need of regular care or maintenance with a view to extending its service life. All the ball-shape bearings used in this motor have their longer service life records. Additionally, they are easy to replace.
4. Deviative vibrating vanes : In setting-up operation, it must be adjusted to produce adequate vibrating force and then to have it fixed at both ends.
5. Outlet cord: The extension cord at outlet is subject to damage due to vibrating, so it is double protected by metal and rubber sleeves.
6. The beads service life: As the service life of steel beads is various with types ; all of them are marked with the service life more than 3000 hours, that is certainly staggering.
7. This motor can run long time.
8. In case, customers want their motors to be water-proof, and explosion-proof or to be made in accordance with their own specification, a specific order can be placed to meet the requirement.

## 半剖面圖 Semi-Cross-Sectional View

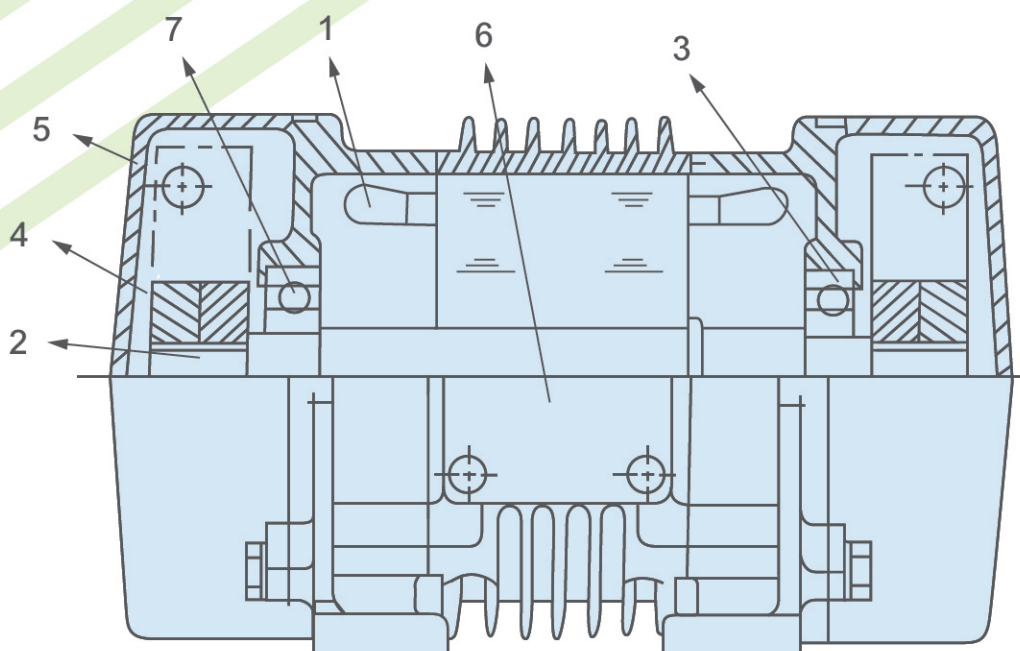

# 電動振動馬達 VIBRATING MOTOR

## ■ 用途

一般使用範圍極為廣泛，產業界的充填壓縮，流出選別，搬運等方面之利用。

充 填	◀ 混泥土、電池工廠、金屬變管、砂之填壓
轉 壓	◀ 振動滾筒、泥土壓縮
流 出	◀ 產金界的漏斗振動用
選 別	◀ 篩選物料大小
振 動 台	◀ 各種振動台、鑄物砂掉落
搬 運	◀ 振動運輸帶
乾燥輸送	◀ 其他

## Usage

Its application is versatile, such as banking / pouring compaction, out-flowing selection, and shipping / handling operations in industrial filed.

- Banking / pouring / filling: Used in civil engineering, by battery factory, metal plumbery manufacturers, or sand filling / compaction operation etc.
- Compaction: Used on vibrating rollers, or cement compaction.
- Outflowing: Used on hoppers in industrial filed.
- Selection: For Screening Material Size.
- Vibrating stand : Used on various vibrating stand to remove the casting sand.
- Shipping / handling: Used to drive the conveying belt.
- Drying transfer purpose.





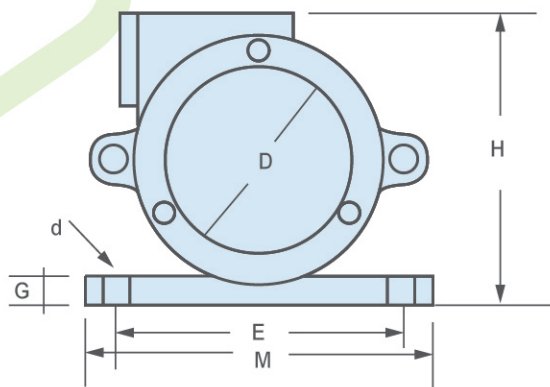
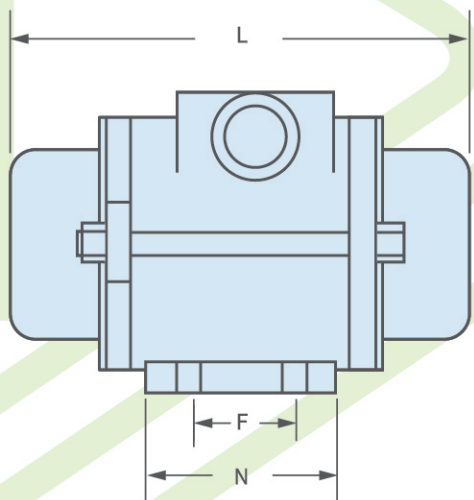
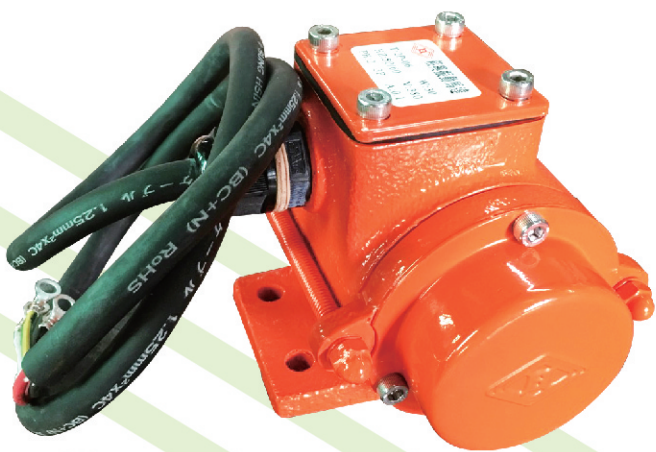

尺寸 型式 Size Type	振動力 Vibration energy(kg)	出力 Output		電壓 Voltage (v)	振動數 Vibrations per min	D	E	F	G	H	L	M	N	d
		KW	Hp											
<b>2P-06</b>	40	30W		110/220	3450	60	92	33	9.5	95	145	112	60	8

# 電動振動馬達 VIBRATING MOTOR



- 不 銹 鋼
- 耐 酸 碱
- 防 腐 蝕
- 易 維 修
- 振 動 馬 達

**Stainless Steel**  
**Acid and Alkal**  
**Prevent-Corrosion**  
**Easy to Repair**  
**Vibration Motor**



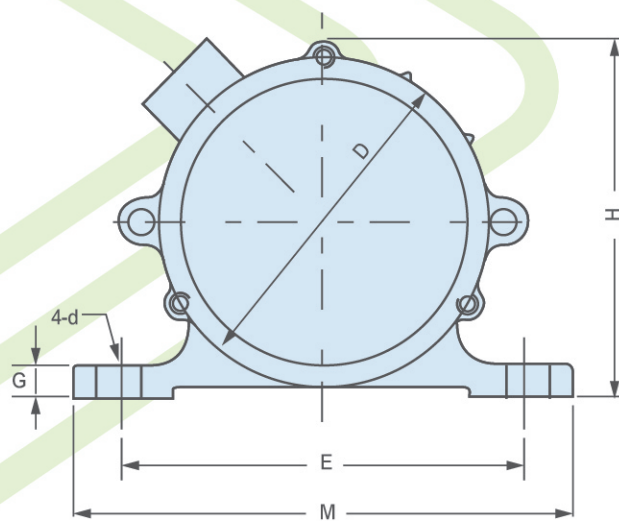
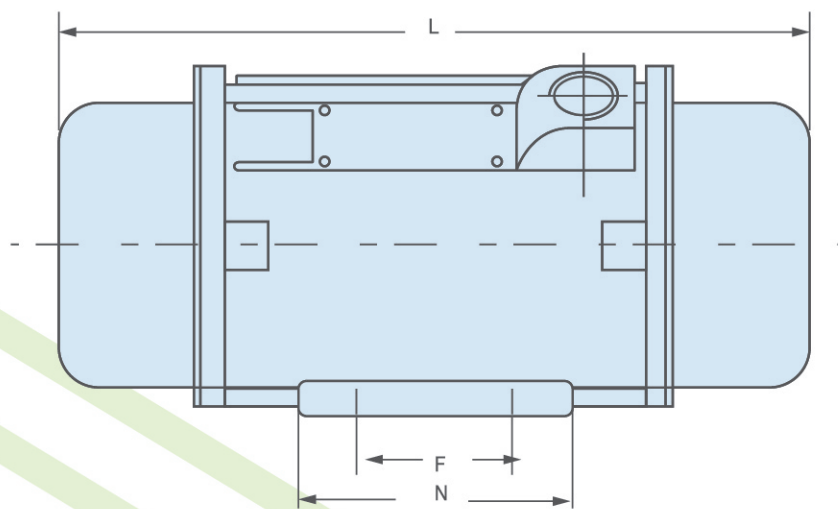

尺寸 型式 Size Type	振動力 Vibration energy (kg)	出力 Output		電壓 Voltage (v)	振動頻率 R.P.M	重量 Kg	D	E	F	G	H	L	M	N	d
		KW	HZ												
<b>2P-03S</b>	40	30W	50/60	1Ø110V	3000/3600	3.1	70	92	36	7	77	177	112	73	9X13
<b>2P-05S</b>	50	50W		1Ø220V		3.1	70	92	36	7	77	177	112	73	9X13
<b>2P-10S</b>	70	75W		3Ø220V		4.4	81	101	36	8.5	88	190	124	68	11X14
				3Ø380V											

# 電動振動馬達 VIBRATING MOTOR

## ■ 二極 2 poles

尺寸 型式 Size Type	振動力 Vibration energy (kg)	出力 Output		電壓 Voltage (v)	振動數 Vibrations per min	D	E	F	G	H	L	M	N	d
		KW	Hp											
<b>2P-10</b>	75	0.075	1/10	220	3450	103	115	40	15	110	210	150	73	13.5
<b>2P-11</b>	150	0.1	1/8	220	3450	113	120	140	15	144	255	155	175	16
<b>2P-15</b>	350	0.25	1/3	220	3450	150	150	106	15	155	255	190	158	18
<b>2P-18</b>	600	0.4	1/2	220	3450	180	180	102	16	187	305	227	173	21
<b>2P-21</b>	1000	0.75	1	220	3450	210	210	120	21	220	340	260	200	22.5
<b>2P-24</b>	2000	1.5	2	220	3450	240	250	220	27	265	470	325	315	25

## ■ 電動馬達各型式部分尺寸 The dimension or size various electric motors

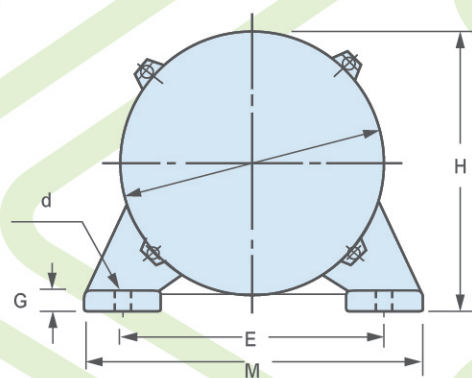
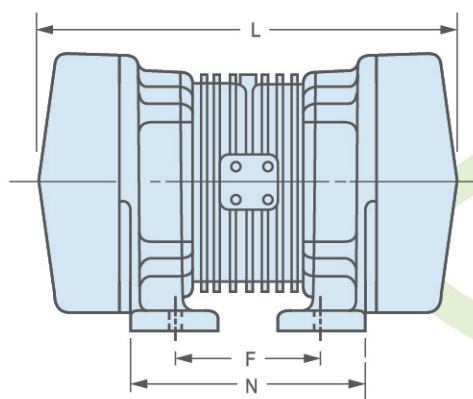

## ■ 四極 4 poles

尺寸 型式 Size Type	振動力 Vibration energy (kg)	出力 Output		電壓 Voltage (v)	振動數 Vibrations per min	D	E	F	G	H	L	M	N	d
		KW	Hp											
<b>4P-11</b>	100	0.1	1/8	220	1750	113	120	140	15	144	255	155	175	16
<b>4P-12</b>	250	0.125	1/6	220	1750	150	150	106	15	155	254	190	158	18
<b>4P-18</b>	500	0.2	1/4	220	1750	180	180	102	16	187	305	227	173	21
<b>4P-21</b>	800	0.4	1/2	220	1750	210	210	120	21	220	340	260	200	22.5
<b>4P-24</b>	1600	0.75	1	220	1750	240	260	143	27	265	385	324	237	25
<b>4P-28</b>	2400	1.12	1 1/2	220	1750	275	260	150	35	285	420	325	240	27
<b>4P-31</b>	3200	1.5	2	220	1750	310	310	190	40	330	545	395	318	33
<b>4P-35</b>	5000	2.2	3	220	1750	350	380	240	50	365	600	480	395	36
<b>4P-40</b>	7500	3.7	5	220	1750	400	380	290	58	450	700	510	468	39





## ■ 六極 6 poles

尺寸 型式 Size Type	振動力 Vibration energy (kg)	出力 Output		電壓 Voltage (v)	振動數 Vibrations per min	D	E	F	G	H	L	M	N	d
		KW	Hp											
6P-21	400	0.25	1/3	220	1150	210	210	120	21	220	340	260	200	22.5
6P-24	800	0.4	1/2	220	1150	240	260	143	27	265	385	324	237	25
6P-28	1600	0.75	1	220	1150	275	260	150	35	285	420	325	240	27
6P-31	2400	1.5	2	220	1150	310	310	190	45	330	560	405	330	33
6P-35	4000	2.2	3	220	1150	350	380	240	50	365	600	480	395	36
6P-40	5800	3.75	5	220	1150	400	380	290	58	450	700	510	468	39
6P-48	7500	5.5	7.5	220	1150	470	440	280	45	480	700	550	430	44
6P-50	10500	7.5	10	220	1150	480	440	390	60	500	890	540	575	44
6P-45A	7500	9	12	220	1150	450	500	500	90	485	980	620	620	38

## ■ 電動馬達各型式部分尺寸 The dimension or size various electric motors

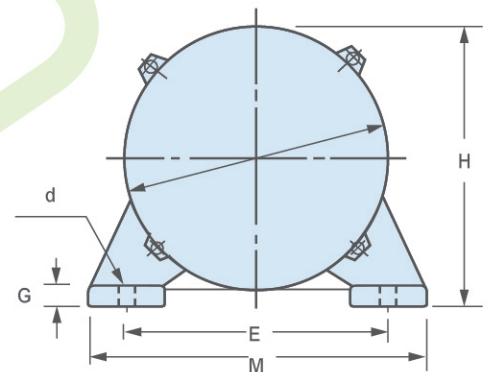
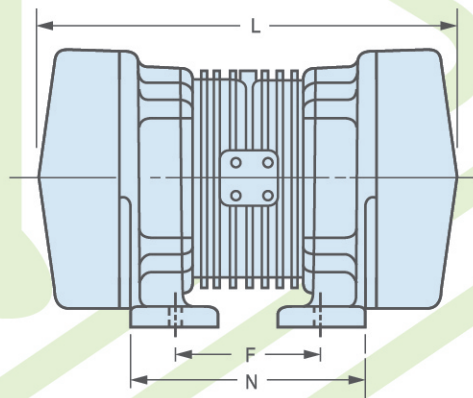

## ■ 八極 8 poles

尺寸 型式 Size Type	振動力 Vibration energy (kg)	出力 Output		電壓 Voltage (v)	振動數 Vibrations per min	D	E	F	G	H	L	M	N	d
		KW	Hp											
8P-24	500	0.4	1/2	220	850	240	260	143	27	265	385	324	237	25
8P-31	1000	0.75	1	220	850	310	310	190	40	330	545	395	318	33
8P-35	2000	1.5	2	220	850	350	380	240	50	365	600	480	395	36
8P-40	3000	2.2	3	220	850	400	380	290	58	450	700	510	468	39
8P-48	5000	3.7	5	220	850	470	440	280	45	480	680	550	430	44
8P-49	6500	5.5	7 1/2	220	850	480	440	390	60	500	835	550	575	44
8P-50A	8500	5.5	10	220	850	480	440	390	60	500	900	550	575	44

# 內轉齒輪泵浦 INTERNAL-TURNED GEAR-PUMP

## 內轉齒輪泵浦用途

- 1.石油工業:重油.柴油.瀝青及各種潤滑油。
- 2.食品工業:糖漿.糖蜜.果漿.果汁.沙拉油.番茄醬。
- 3.染料.油漆.溶劑.色料.塗料。
- 4.化學工業:膠.糊.清潔劑.藥劑.樹脂.肥皂。

## 選用要點

- 1.查明液體物性、黏度、比重、溫度等，以選配轉速，核算馬力機種。(參考曲線圖)
- 2.查明液化性，以選定泵浦材質及機械軸封，填料等材質。
- 3.本泵浦防洩方式有①機械油封。② 填料二種，前者適合於比重輕，濃度低之液體可快速運轉。後者適合於液化性較強，濃度特別高之液體，視其需要選擇使用。
- 4.機械軸封採用日本NSO軸封，一般用耐溫100°C，特製150°C。

## 規格性能表

型式號碼		出口口	正常定律		推薦馬達馬力 (黏度100 SSU液體)		最高容許溫度 (°C)		總重量
填料	機械油封	尺寸(吋)	出油量 加侖/分	每分鐘 轉速	壓力		填料	機械 油封	(kg)
					3.5kg/cm <sup>2</sup>	7kg/cm <sup>2</sup>			
		1/2"	4	1200	1/2	3/4		100	6
		3/4"	6.5	1200	3/4	1		100	7
	GG 195	1"	10	1800	3/4	1	200	100	8
			7	1200	1/2	3/4			
SH124	HL4124	1 1/2"	30	1800	2	3	200	100	18
			20	1200	1 1/2	2			
SH124	K 4124	2"	60	640	5	7 1/2	200	100	48
			30	320	3	5			

## 內轉齒輪泵浦運轉方向指示圖

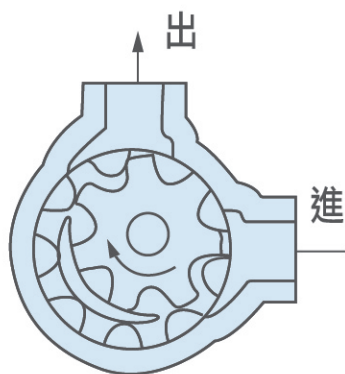

## 運轉注意事項

- 1.運轉前泵浦裡必須積有液體盡量避免空轉以保持泵浦之性能。
- 2.裝配管路時，嚴禁金屬類雜物進入泵浦，以免損壞泵浦。
- 3.吸入管不要小於泵浦口徑，以維持泵浦性能。
- 4.運轉中有雜音時應停止操作，檢查泵浦內是否有雜物進入，或管路有無阻塞、液體不足等。
- 5.有沉澱性的液體，停車前最好幾另種液體沖洗。
- 6.最好於吸入管前裝置過濾器，防止雜物吸入泵浦。
- 7.高黏度液體請勿裝安全閥，逆止閥。





# 內轉齒輪泵性能曲線圖

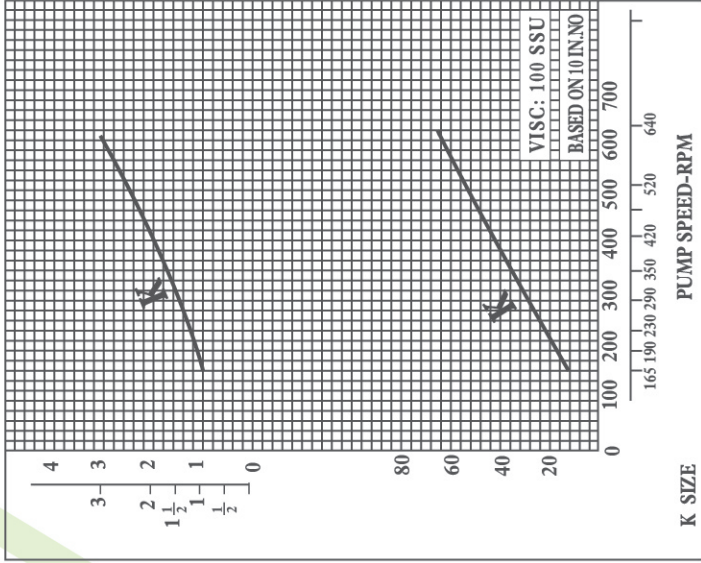
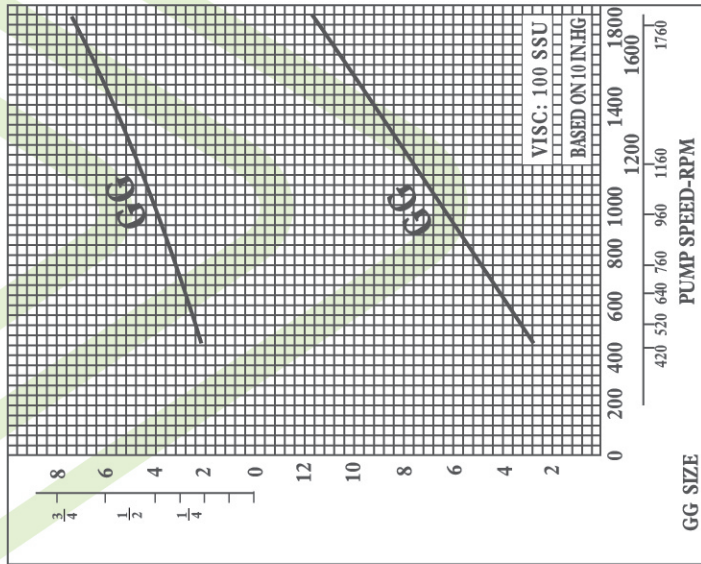
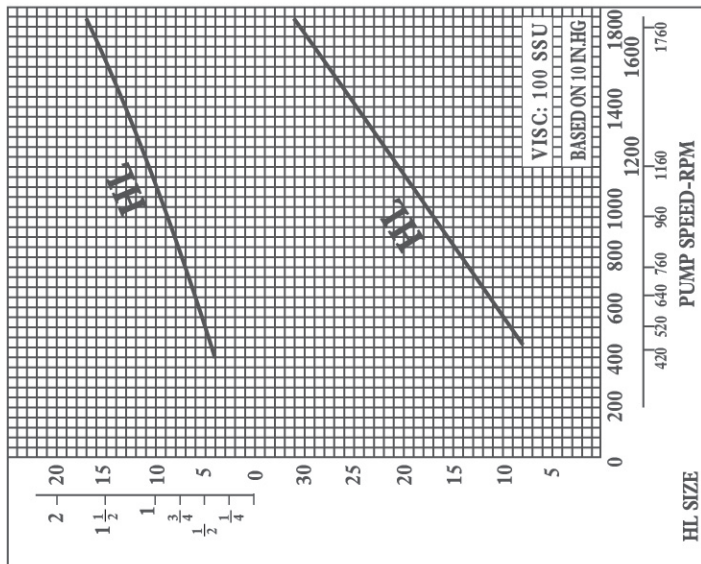

# 內轉齒輪泵浦 INTERNAL-TURNED GEAR-PUMP

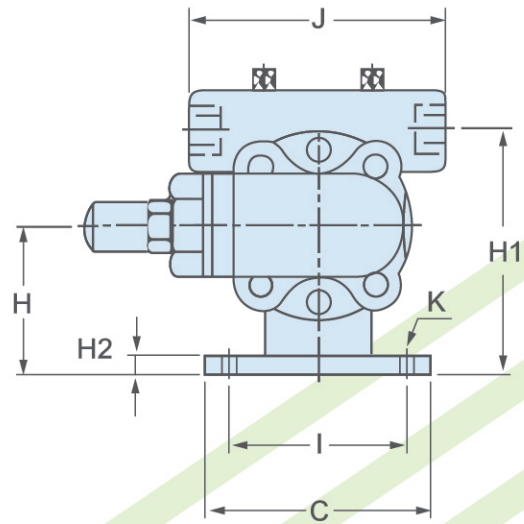
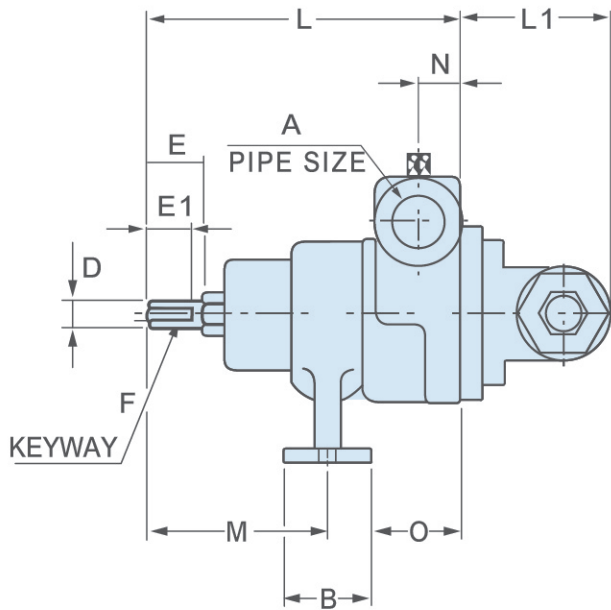

型號	機械軸封	A	B	C	D	E	E1	F	G	H	H1	H2	I	J	K	L	L1	M	N	O
SH-04	3-15	1/2"	41	110	12	25	22	FLAT		71	115	10	83	123	11	153	70	90	24	40
SH-06	3-15	3/4"	41	110	12	25	22	FLAT		71	115	10	83	123	11	150	70	92	24	42

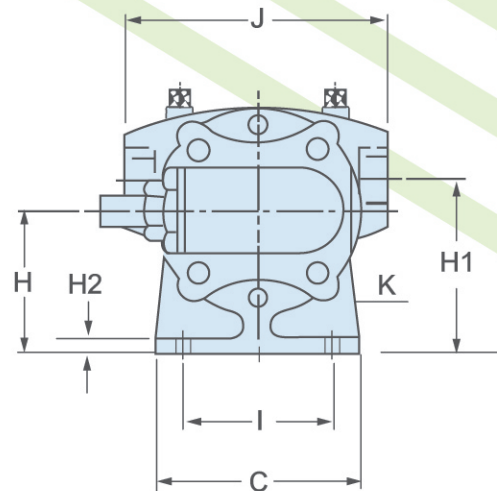
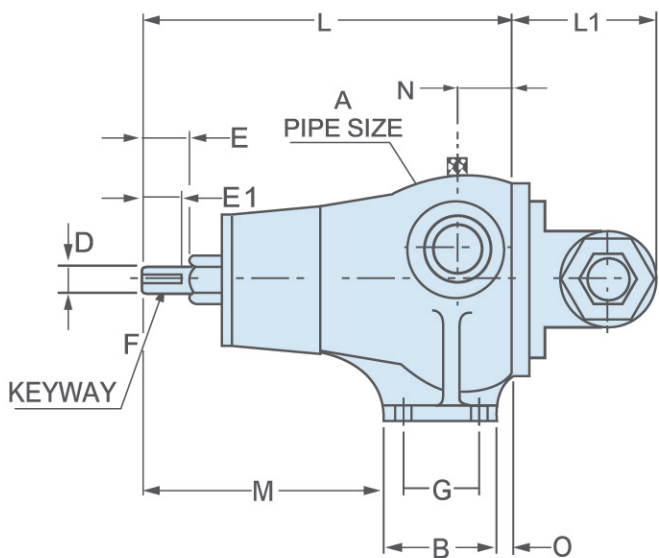

型號	機械軸封	A	B	C	D	E	E1	F	G	H	H1	H2	I	J	K	L	L1	M	N	O
SH-08	3-25	1"	59	108	16	28	25	5X5	35	70	86	13	82	150	9	195	72	140	32	9

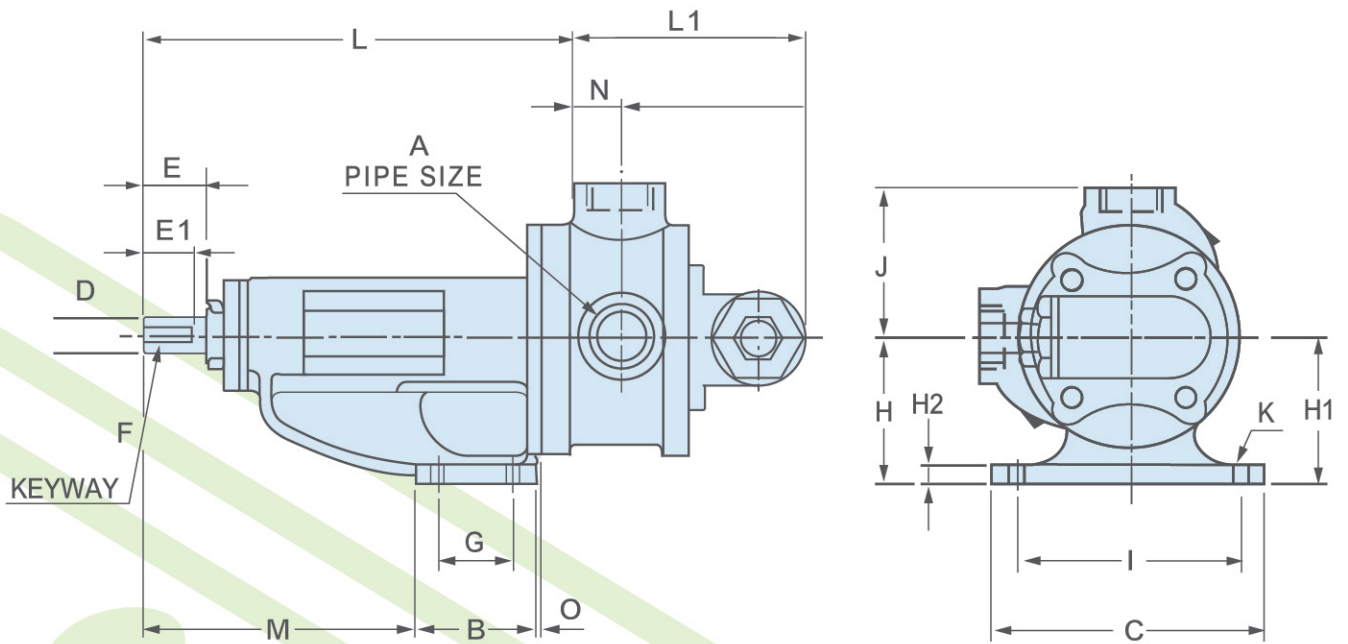

型號	機械軸封	A	B	C	D	E	E1	F	G	H	H1	H2	I	J	K	L	L1	M	N	O
SH-12	305-30	1½"	90	172	22	41	38	6X6	57	89	89	15	140	80	11	265	134	150	32	43

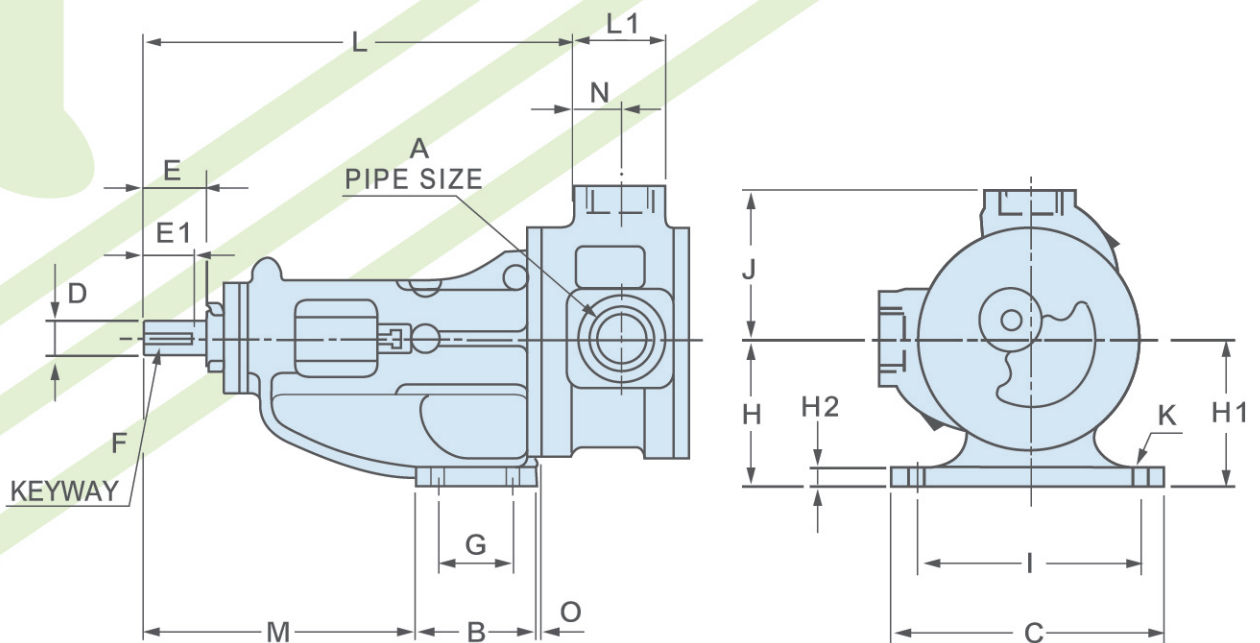

型號	機械軸封	A	B	C	D	E	E1	F	G	H	H1	H2	I	J	K	L	L1	M	N	O
SH-16	305-40	2"	140	240	30	53	50	7X7	100	140	140	19	180	137	16	325	88	170	44	10





# 崧興工業股份有限公司

Sung Hsin Industry Co., Ltd.

始終追求卓越品質

經銷商／



**謝宗翰**

Cel:0905393089

**豐辰有限公司**

FENCHENLIMITED COMPANY

TEL:(07)6230289

FEX:(07)6230685

SINCE 2006

地址:(820)高雄市岡山區本洲路317號