

GONGJI®

G5

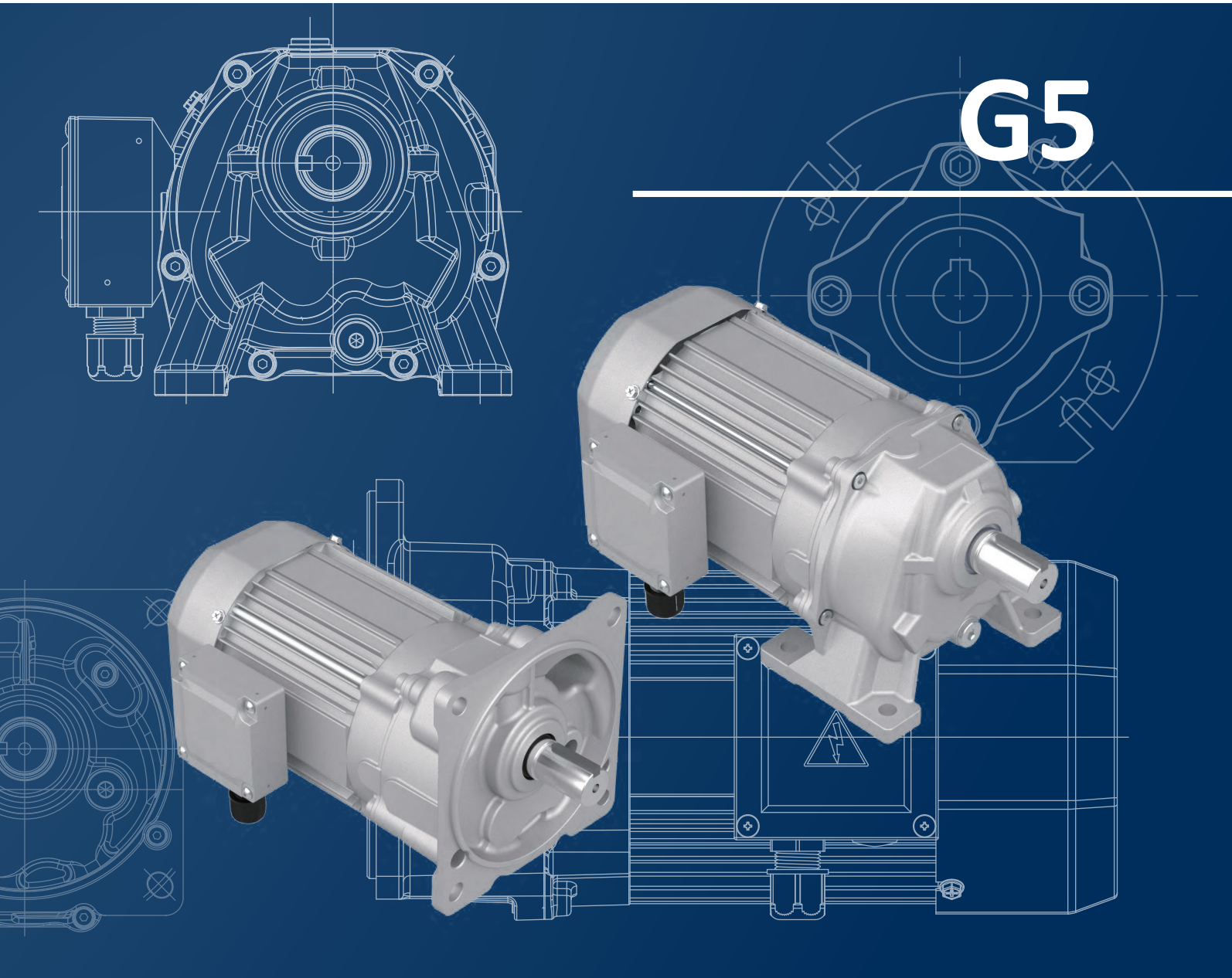

齒輪減速馬達
GEARMOTOR

TAIWAN GONG JI CHANG CO., LTD.

尺寸表 Dimensions

機型 Type : G5BA

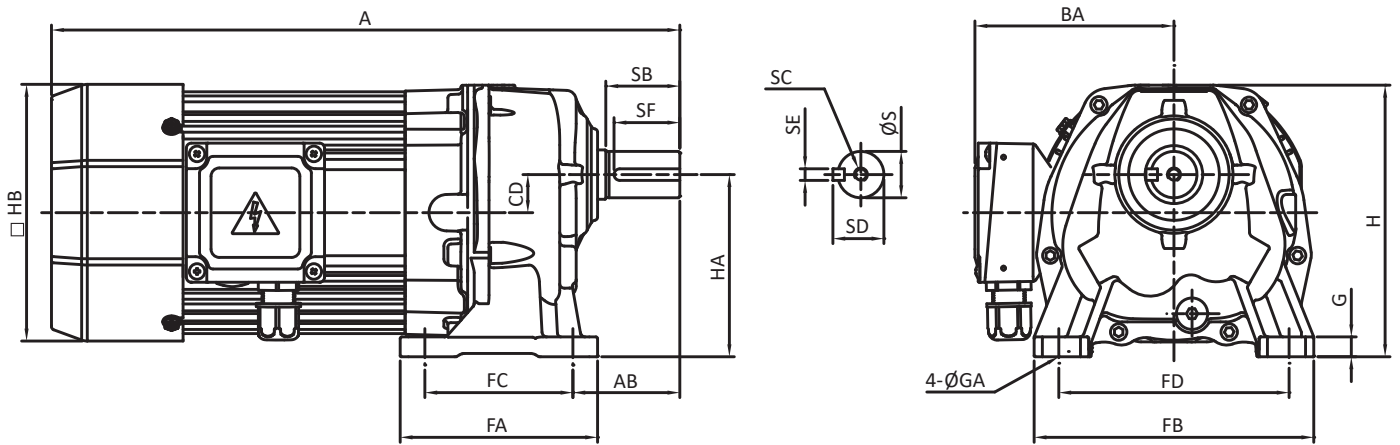

規格 Size	A (kW)							AB	AC	BA	CD	FA	FB	FC	FD	G
	0.1	0.18	0.37	0.75	1.5	2.2	3.7									
18	263	283	308	-	-	-	-	49	40	105	18	65	132	40	110	10
22	274	294	319	-	-	-	-	56	45	105	18	90	152	65	130	10
28	298	318	343	382	437	-	-	65	55	121	23	120	170	90	140	12
32	-	-	384	408	463	-	-	76	64	121	27.5	160	210	130	170	15
40	-	-	-	438	493	502	542	92	72	142	35	200	260	150	210	22
50	-	-	-	462	517	526	566	104	87	142	40	214	312	170	265	28

規格 Size	GA	H	HA	HB	S	SB	SC	SD	SE	SF	YA	YB	YC	YD	YE	YF
18	10	126	85	120	18	35	M6*12	20	5	30	78	120	-	42	10	-
22	11	132	90	120	22	40	M6*12	25	7	35	79	158	148	79	12	185
28	12	164	110	155	28	45	M8*16	31	7	40	94	180	170	90	12	220
32	13	201	130	155	32	55	M8*16	35	10	50	110	220	185	110	15	255
40	15	241	162	193	40	65	M10*20	43	10	60	133	266	230	133	18	310
50	18	287	193	193	50	80	M10*20	53.5	14	75	158	316	280	158	25	390

機型 Type : G5FA

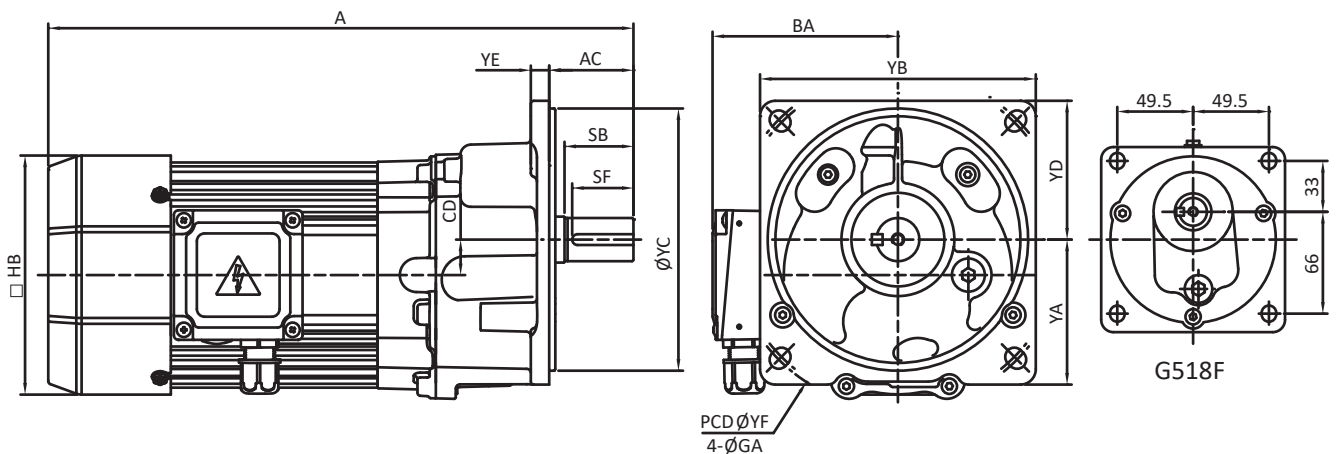

機型 Type : G5BM

機型 Type : G5FM

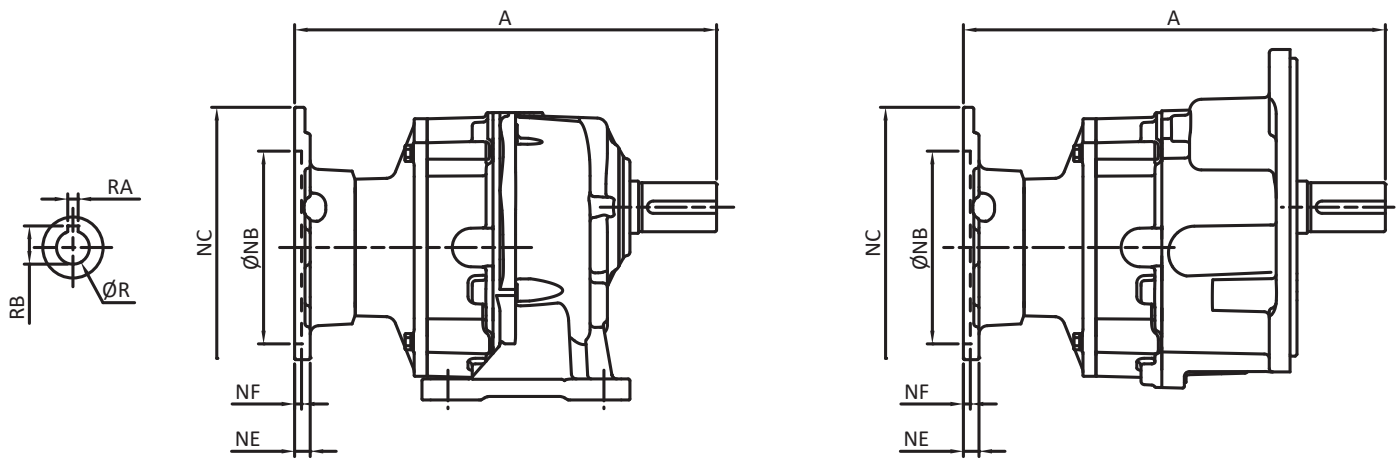

功率 kW	IEC 框號 Frame		R	RA	RB	NB	NC	ND	NE	NF	NG	NH	18	22	28	32	40	50
													A					
0.18 kW (1/4 HP)	D63	B5	11	4	12.8	95	140	115	10	4	9	M8	180	191	214	256	-	-
		B14				60	90	75	5	4	6	M5	178	189	212	254	-	-
	D67	B5				110	160	130	8	4	9	M8	178	189	212	254	-	-
0.37 kW (1/2 HP)	D71	B5	14	5	16.3	110	160	130	8	4	9	M8	178	189	212	254	-	-
		B14				70	105	85	7	4	7	M8	178	189	212	254	-	-
0.75 kW (1 HP)	D80	B5	19	6	21.8	130	200	165	10	4	11	M10	-	-	248.5	274	304	329
		B14				80	120	100	7	4	7	M6	-	-	250.5	276	306	331
1.5 kW (2 HP)	D90	B5	24	8	27.1	130	200	165	10	4	11	M10	-	-	248.5	274	304	329
		B14				95	140	115	7	4	9	M8	-	-	250.5	276	306	331
2.2 kW (3 HP)	D100	B5	28	8	31.3	180	250	215	12	4	M12	-	-	-	-	-	340	364
		B14				110	160	130	11	4	9	-	-	-	-	-	-	*340
3.7 kW (5 HP)	D112	B5	28	8	31.3	180	250	215	12	4	M12	-	-	-	-	-	340	364
		B14				110	160	130	11	4	9	-	-	-	-	-	-	*340

* 安裝孔位置為90° Mounting hole position 90°

入力法蘭 Input Flange

IEC-B5

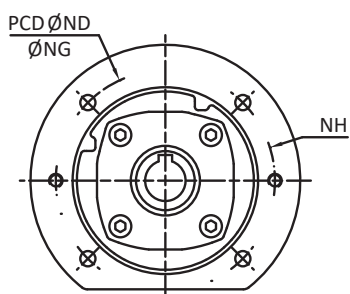

IEC-B14

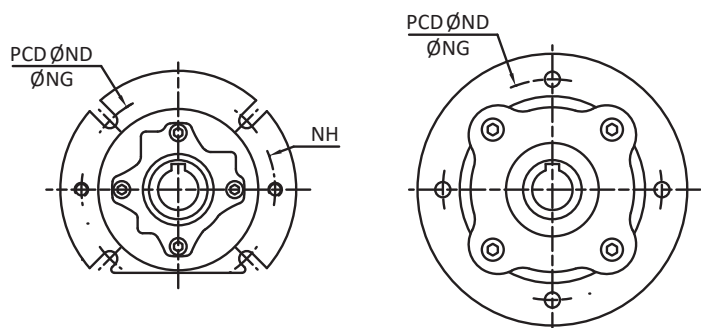

安裝孔位置為90°
Mounting hole position 90°

機型 Type : G5BS

機型 Type : G5FS

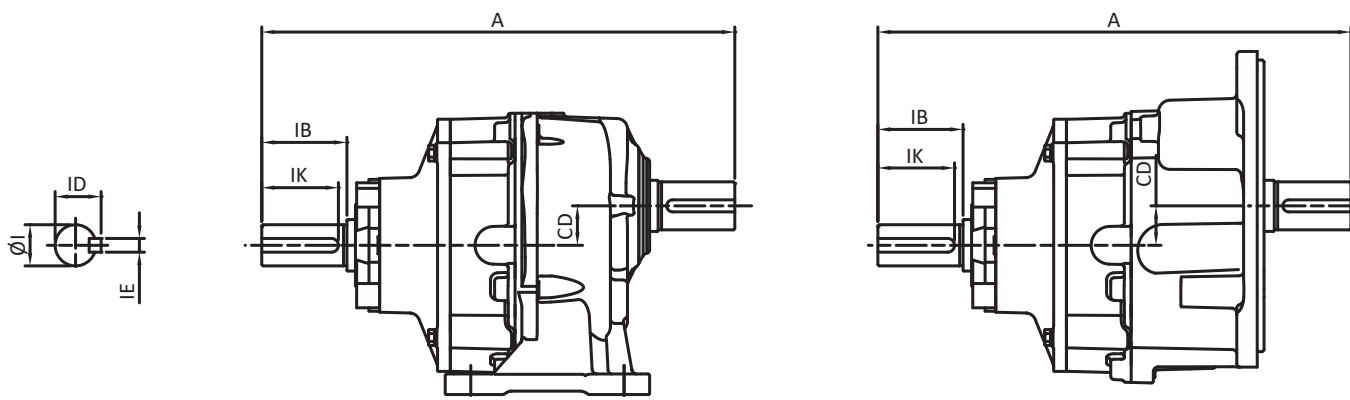

功率 kW	規格 Size	減速比 Ratio	A	I	IB	ID	IE	IK
0.1 kW (1/8 HP)	18	3-30	183	14	30	16	5	25
		35-80	195					
	22	40-180	206					
	28	80-200	229.5					
0.18 kW (1/4 HP)	18	3-30	183					
		35-40	195					
	22	25-30	194					
		35-90	206					
	28	50-150	229.5					
32	80-200	271						
0.37 kW (1/2 HP)	18	3-20	183					
	22	3-30	194					
		35-40	206					
	28	12-70	229.5					
0.75 kW (1 HP)	32	40-130	271					
	28	3-40	272	19	40	21.5	6	35
		32	20-70					
	40	40-120	327.5					
50	60-200	352						
1.5 kW (2 HP)	28	3-20	282	24	50	27	8	45
	32	3-30	307.5					
	40	20-60	337.5					
	50	40-120	362					
2.2 kW (3 HP)	40	3-40	372.5	28	55	31	8	50
	50	20-80	396.5					
3.7 kW (5 HP)	40	3-25	372.5					
	50	7-50	396.5					

性能表 Ratings Table

減速比 Ratio	50 Hz							60 Hz						
	0.1 kW	0.18kW	0.37kW	0.75kW	1.5kW	2.2kW	3.7kW	0.1kW	0.18kW	0.37kW	0.75kW	1.5kW	2.2kW	3.7kW
3	1.8	3.2	6.6	12.9	25.6	37.5	63.1	1.5	2.6	5.5	10.8	21.3	31.2	52.6
5	3.0	5.3	11.0	21.5	42.6	62.5	105	2.5	4.4	9.2	17.9	35.5	52.1	87.6
10	6.0	10.6	22.0	43.1	85.2	125	210	5.0	8.8	18.3	35.9	71.0	104	175
15	9.0	15.8	33.0	64.6	128	187	315	7.5	13.2	27.5	53.8	107	156	263
20	12.0	21.1	44.0	86.2	170	250	420	10.0	17.6	36.7	71.8	142	208	350
25	15.0	26.4	55.0	108	213	312	526	12.5	22.0	45.8	89.7	178	260	438
30	16.9	29.8	62.1	121	240	353	593	14.1	24.8	51.7	101	200	294	494
40	22.5	39.7	82.7	162	321	470	791	18.8	33.1	69.0	135	267	392	659
50	28.2	49.6	103	202	401	588	988	23.5	41.4	86.2	169	334	490	824
60	33.8	59.6	124	243	481	705	1186	28.2	49.6	103	202	401	588	988
70	39.4	69.5	145	283	561	823	-	32.9	57.9	121	236	467	686	-
80	45.1	79.4	165	324	641	940	-	37.5	66.2	138	270	534	783	-
90	50.7	89.4	186	364	721	1058	-	42.2	74.5	155	304	601	881	-
100	56.3	99.3	207	405	801	1175	-	46.9	82.7	172	337	668	979	-
120	67.6	119	248	486	962	-	-	56.3	99.3	207	405	801	-	-
140	78.9	139	290	567	1122	-	-	65.7	116	241	472	935	-	-
160	90.1	159	331	648	1282	-	-	75.1	132	276	540	1068	-	-
180	101	179	372	729	1442	-	-	84.5	149	310	607	1202	-	-
200	113	199	414	810	-	-	-	93.9	165	345	675	-	-	-

* 輸出扭力 Output torque = Nm

選配表 Selection Table

功率 kW	18#	22#	28#	32#	40#	50#
0.1 kW	3~80	40~180	80~200	160~200	-	-
0.18 kW	3~40	25~90	50~150	80~200	-	-
0.37 kW	3~20	3~40	12~70	40~130	-	-
0.75 kW	-	-	3~40	20~70	40~120	60~200
1.50 kW	-	-	3~20	3~30	20~60	40~120
2.20 kW	-	-	-	-	3~40	20~80
3.75 kW	-	-	-	-	3~25	7~50

* 減速比 Ratio

線盒及入線孔方向 Terminal Box Position

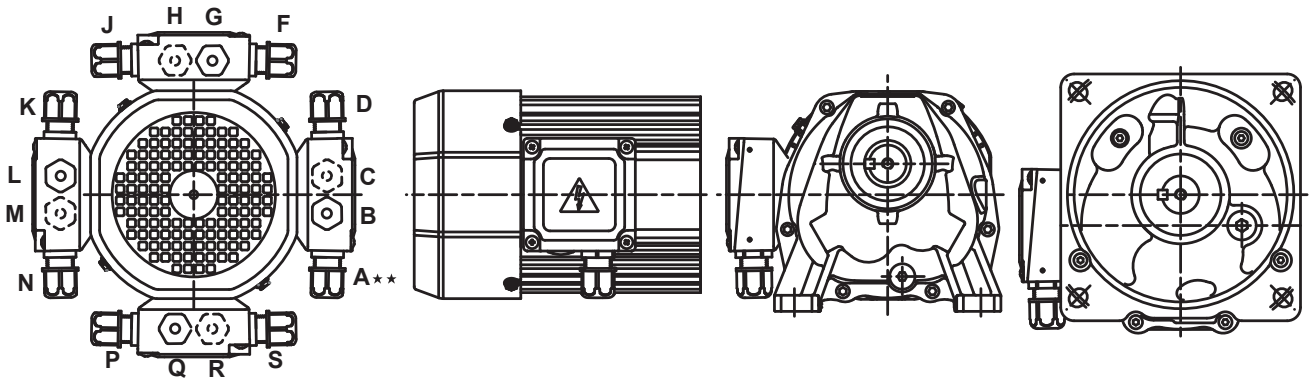

** 標準接線盒方向
Standard Position

結線圖 Connection Diagram

6 條結線
6 Lead

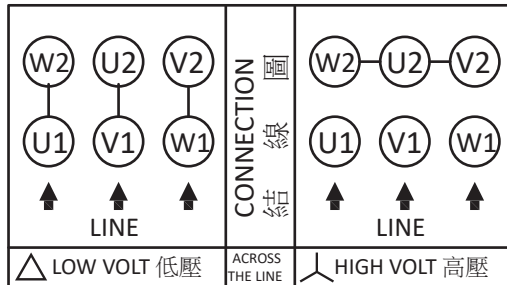

9 條結線
9 Lead

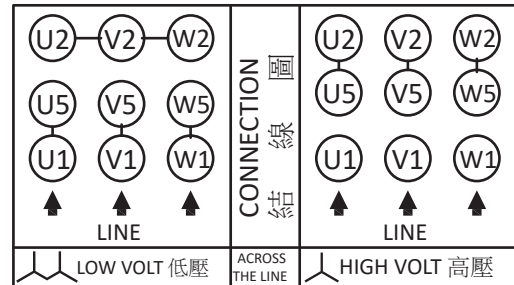

6 條結線附煞車整流器
6 Lead With Rectifier

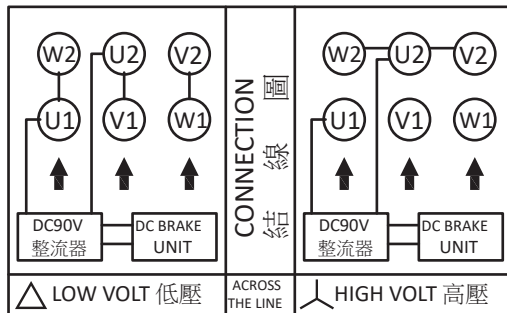

9 條結線附煞車整流器
9 Lead With Rectifier

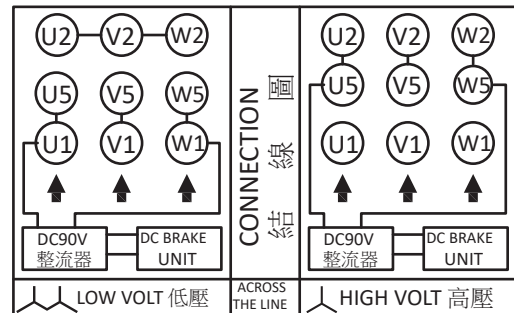

No. 1, Alley 15, Ln. 39, Neixi Rd.
Luzhu, Taoyuan, Taiwan R.O.C.
T : +886-3-3241000
F : +886-3-3245566
E : info@gongjdrive.com